

FOR PAGE SWITCH

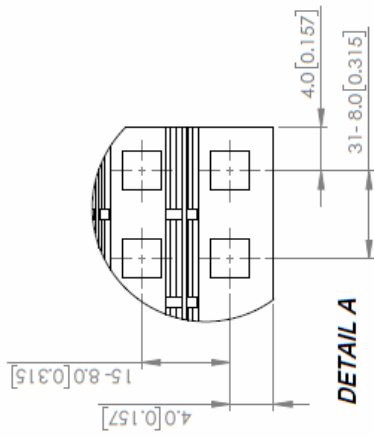
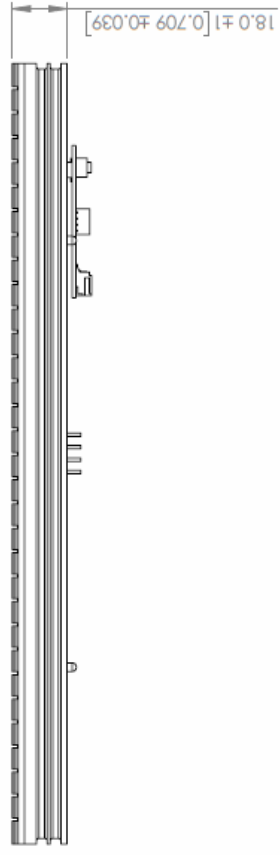
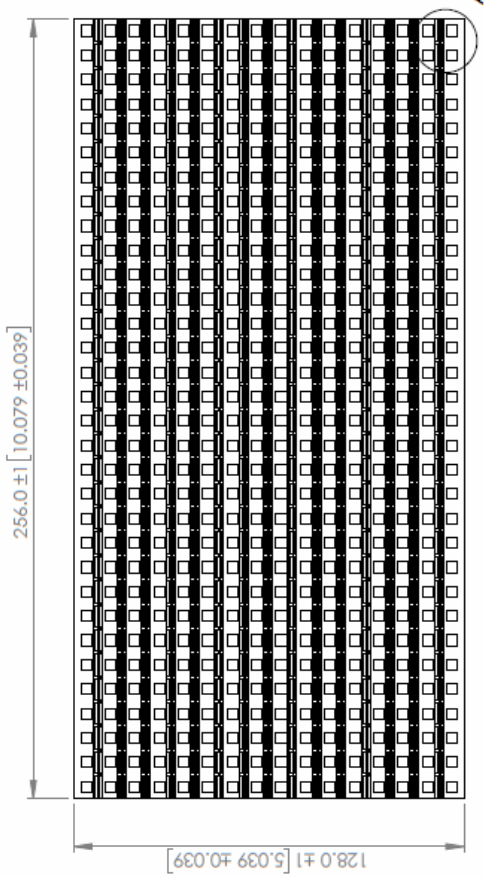

DETAIL A

*UNLESS OTHERWISE SPECIFIED TOLERANCES PER DECIMAL PRECISION ARE: X±1 (±0.039), X-X±0.5 (±0.020), X-X±1 (±0.010), X-XXX±0.127 (±0.005), LEAD SIZE=±0.05 (±0.002), LEAD LENGTH=±0.75 (±0.030), MIN=-0.00

ezDisplay P8 OUTDOOR DOT MATRIX, 32*16 PIXEL, RGB LEDs, UART INTERFACE.

MAX = +0.00
MIN = -0.00

SUNLIKE DISPLAY TECH. CORP. Web: www.lcd-modules.com.tw

DATE : 2018.07.12 DRAWN BY : C.C.
 PAGE : 1 OF 6 CHKD BY : E.C.
 SCALE : NTF APRVD BY : G.Y.
 UNIT : mm [INCH]

THE INFORMATION CONTAINED IN THIS DOCUMENT IS THE PROPERTY OF SUNLIKE. EXCEPT AS SPECIFICALLY AUTHORIZED IN WRITING BY SUNLIKE, THE HOLDER OF THIS DOCUMENT SHALL KEEP ALL INFORMATION CONTAINED HEREIN CONFIDENTIAL AND SHALL PROTECT SAME IN WHOLE OR IN PART FROM DISCLOSURE AND DISSEMINATION TO ALL THIRD PARTIES.

CONFIDENTIAL INFORMATION

THE SPECIFICATIONS MAY CHANGE AT ANY TIME WITHOUT NOTICE DUE TO NEW MATERIALS OR PRODUCT IMPROVEMENT.

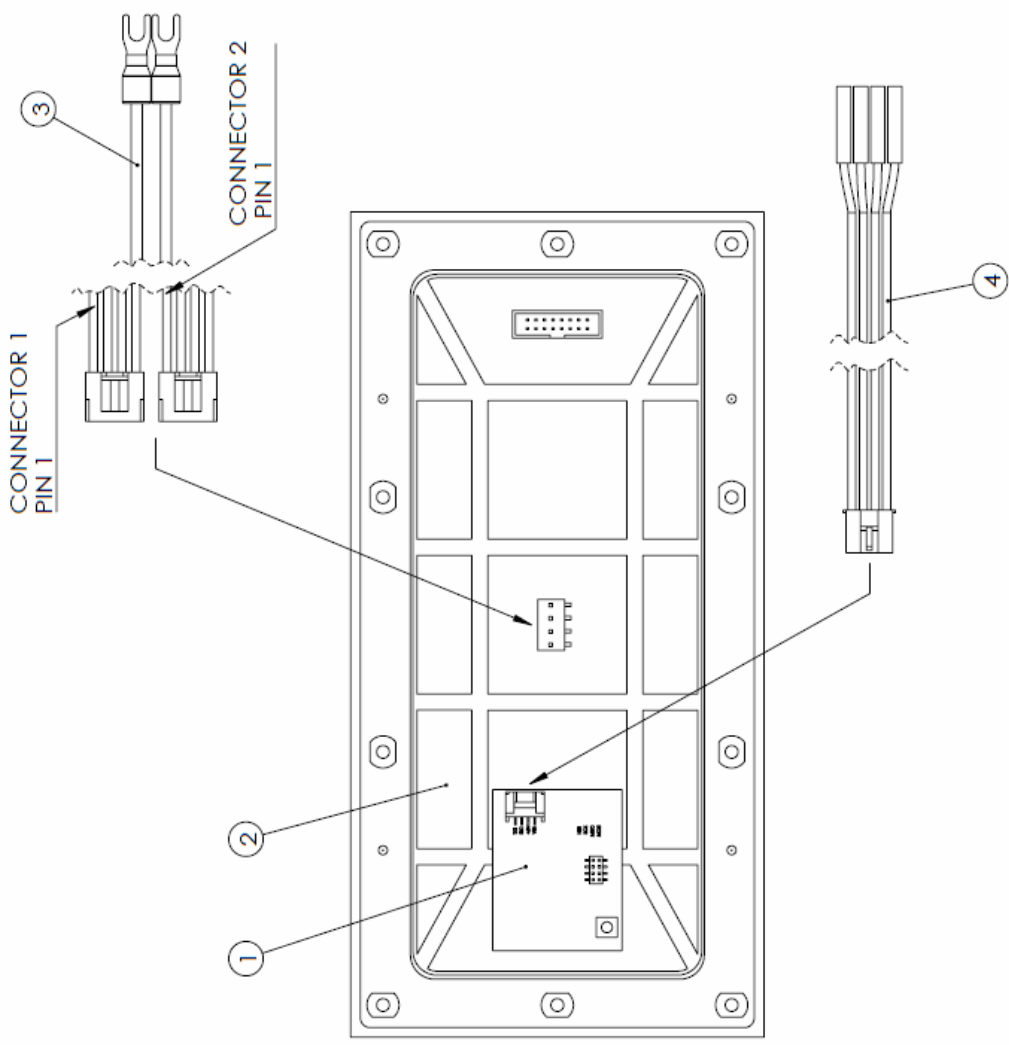

WIRELEAD DEFINITION

PIN	PIN NO	COLOR	DEFINITION
WIRE002	1	YELLOW	TX1
	2	WHITE	RX1
	3	RED	5V
	4	BLACK	GND
WIRE008	1	RED	ANODE DC 5V POWER IN
	2		
	3		
	4	BLACK	CATHODE

COMPONENT

ITEM	P/N	QTY.
1	LDM-3216-1LT-RGB-E	1
2	LDM-3216-P8-PCB	1
3	WIRE008	1
4	WIRE002	1

*UNLESS OTHERWISE SPECIFIED TOLERANCES PER DECIMAL PRECISION ARE: X=+1 (±0.039), X-X=+0.5 (±0.020), X-X=+0.5 (±0.010), X-XXX=+0.127 (±0.005), LEAD SIZE=+0.05 (±0.002), LEAD LENGTH=+0.75 (±0.030), MIN=-0.000, MAX = +0.000, *DECIMAL PRECISION, MIN=-0.000, MAX = +0.000, *DECIMAL PRECISION

ezDisplay P8 OUTDOOR DOT MATRIX, 32*16 PIXEL, RGB LED's, UART INTERFACE.

THE SPECIFICATIONS MAY CHANGE AT ANY TIME WITHOUT NOTICE DUE TO NEW MATERIALS OR PRODUCT IMPROVEMENT.

CONFIDENTIAL INFORMATION
 THE INFORMATION CONTAINED IN THIS DOCUMENT IS THE PROPERTY OF SUNLIKE. THE HOLDER OF THIS DOCUMENT SHALL KEEP ALL INFORMATION CONTAINED HEREIN CONFIDENTIAL AND SHALL PROTECT SAME IN WHOLE OR IN PART FROM DISCLOSURE AND DISSEMINATION TO ALL THIRD PARTIES.

GENERAL SPECIFICATION

ITEM	DESCRIPTION	UNIT
MODULE SIZE	256(L) × 128(W)	mm
PIXEL PITCH	8	mm
PIXEL FORM	RGB	--
PIXEL DENSITY	111111	dot/m2
MODULE RESOLUTION	32x16	dot
DRIVE METHOD	1/4 SCAN	--
CONTROLLER INTERFACE	UART	--
POWER CONSUMPTION	30 MAX	W
BRIGHTNESS	5000 MIN	cd/m2
TEMPERATURE RANGE	-30~60, 10%~95%RH	°C
FRAME COLOR	BLACK	°C

GENERAL SPECIFICATION

ITEM	SETTING VALUE
BAUD RATE	115200
DATA BIT	8
STOP BIT	1
PARITY BIT	NONE
FLOW CONTROL	NONE

*UNLESS OTHERWISE SPECIFIED TOLERANCES PER DECIMAL PRECISION ARE: X=±1 (±0.039), X.X=±0.5 (±0.020), X.XX=±0.25 (±0.010), X.XXX=±0.127 (±0.005), LEAD SIZE=±0.05 (±0.002), LEAD LENGTH=±0.75 (±0.030), MIN=-0.000 MAX = +0.000 DECIMAL PRECISION
 ezDisplay P8 OUTDOOR DOT MATRIX, 32*16 PIXEL, RGB LEDs, UART INTERFACE.





SUNLIKE DISPLAY TECH. CORP. Web: www.lcd-modules.com.tw

DATE : 2018.07.12 DRAWN BY : C.C.
 PAGE : 3 OF 6 CHKD BY : E.C.
 SCALE : NTF AFRVD BY : G.Y.
 UNIT : mm [INCH]

THE INFORMATION CONTAINED IN THIS DOCUMENT IS THE PROPERTY OF SUNLIKE. THE HOLDER OF THIS DOCUMENT SHALL KEEP ALL INFORMATION CONTAINED HEREIN CONFIDENTIAL AND SHALL PROTECT SAME IN WHOLE OR IN PART FROM DISCLOSURE AND DISSEMINATION TO ALL THIRD PARTIES.

CONFIDENTIAL INFORMATION
 THE SPECIFICATIONS MAY CHANGE AT ANY TIME WITHOUT NOTICE DUE TO NEW MATERIALS OR PRODUCT IMPROVEMENT.

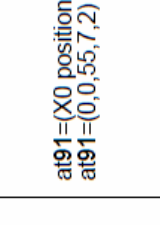

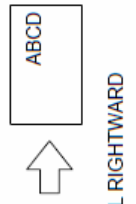
DIAGRAM	COMMAND*	EXAMPLE
	Write a 5x7 RGB String	$ate1=(line, column, Color\ 0\sim255^*, String)$ $ate1=(0,0,4,ABCD)$
	Set a Color Pixel	$atee=(X\ position, Y\ position, Color\ 0\sim255^*)$ $atee=(48,6,96) : '96' Red\ color$
	Draw a Rectangle	$at91=(X0\ position, Y0\ position, X1\ position, Y1\ position, Color\ 0\sim255^*)$ $at91=(0,0,55,7,2) : '2' blue\ color$
	Draw a Circle	$at94=(X\ position, Y\ position, Radius, Color\ 0\sim255^*)$ $at94=(48,4,3,64) : '64' red\ color$
	Draw a tip upward Triangle	$at96=(X\ position, Y\ position, Height, Color\ 0\sim255^*)$ $at96=(48,1,3,4) : '4' green\ color$
	Scroll the whole display rightward	$atd5=(shif\ time\ in\ ms)$ $atd5=(20)$

*UNLESS OTHERWISE SPECIFIED TOLERANCES PER DECIMAL PRECISION ARE: X=±1 (±0.039), X,X=±0.5 (±0.020), X,XX=±0.25 (±0.010), X,XXX=±0.127 (±0.005), LEAD SIZE=±0.05 (±0.002), LEAD LENGTH=±0.75 (±0.030), MIN=-.000, MAX = .000, DECIMAL PRECISION =.000

ezDisplay P8 OUTDOOR DOT MATRIX, 32*16 PIXEL, RGB LEDs, UART INTERFACE.

THE INFORMATION CONTAINED IN THIS DOCUMENT IS THE PROPERTY OF SUNLIKE EXCEPT AS SPECIFICALLY AUTHORIZED IN WRITING BY SUNLIKE. THE HOLDER OF THIS DOCUMENT SHALL KEEP ALL INFORMATION CONTAINED HEREIN CONFIDENTIAL AND SHALL PROTECT SAME IN WHOLE OR IN PART FROM DISCLOSURE AND DISSEMINATION TO ALL THIRD PARTIES.

0	1	2	3	4	5	6	7	8	9	10	11	12	13	14	15
32	33	34	35	36	37	38	39	40	41	42	43	44	45	46	47
64	65	66	67	68	69	70	71	72	73	74	75	76	77	78	79
96	97	98	99	100	101	102	103	104	105	106	107	108	109	110	111

*UNLESS OTHERWISE SPECIFIED TOLERANCES PER DECIMAL PRECISION ARE: X=+1 (±0.039), X-X=+0.5 (±0.020), X-X=+0.25 (±0.010), X-XXX=+0.127 (±0.005), LEAD SIZE=+0.05 (±0.002), LEAD LENGTH=+0.75 (±0.030), MIN=-.000
 *DECIMAL PRECISION MAX = *DECIMAL PRECISION
 ezDisplay P8 OUTDOOR DOT MATRIX, 32*16 PIXEL, RGB LEDs, UART INTERFACE.

DATE : 2018.07.12 DRAWN BY : C.C.
 PAGE : 5 OF 6 CHKD BY : E.C.
 SCALE : NTF APRVD BY : G.Y.
 UNIT : mm [INCH]

THE INFORMATION CONTAINED IN THIS DOCUMENT IS THE PROPERTY OF SUNLIKE. EXCEPT AS SPECIFICALLY AUTHORIZED IN WRITING BY SUNLIKE, THE HOLDER OF THIS DOCUMENT SHALL KEEP ALL INFORMATION CONTAINED HEREIN CONFIDENTIAL AND SHALL PROTECT SAME IN WHOLE OR IN PART FROM DISCLOSURE AND DISSEMINATION TO ALL THIRD PARTIES.
 *THE SPECIFICATIONS MAY CHANGE AT ANY TIME WITHOUT NOTICE DUE TO NEW MATERIALS OR PRODUCT IMPROVEMENT. **
 CONFIDENTIAL INFORMATION

Web: www.lcd-modules.com.tw

SUNLIKE DISPLAY TECH. CORP.



ASCII CODE OF 5X7 FONTS AND 8X16 FONTS

Hex	Symbol	Hex	Symbol	Hex	Symbol
0x20		0x40	@	0x60	`
0x21	!	0x41	A	0x61	a
0x22	"	0x42	B	0x62	b
0x23	#	0x43	C	0x63	c
0x24	\$	0x44	D	0x64	d
0x25	%	0x45	E	0x65	e
0x26	&	0x46	F	0x66	f
0x27		0x47	G	0x67	g
0x28	(0x48	H	0x68	h
0x29)	0x49	I	0x69	i
0x2a	*	0x4a	J	0x6a	j
0x2b	+	0x4b	K	0x6b	k
0x2c	,	0x4c	L	0x6c	l
0x2d	-	0x4d	M	0x6d	m
0x2e	.	0x4e	N	0x6e	n
0x2f		0x4f	O	0x6f	o
0x30	0	0x50	P	0x70	p
0x31	1	0x51	Q	0x71	q
0x32	2	0x52	R	0x72	r
0x33	3	0x53	S	0x73	s
0x34	4	0x54	T	0x74	t
0x35	5	0x55	U	0x75	u
0x36	6	0x56	V	0x76	v
0x37	7	0x57	W	0x77	w
0x38	8	0x58	X	0x78	x
0x39	9	0x59	Y	0x79	y
0x3a	:	0x5a	Z	0x7a	z
0x3b	;	0x5b	[0x7a	{
0x3c	<	0x5c	\	0x7a	
0x3d	=	0x5d]	0x7a	}
0x3e	>	0x5e	^	0x7a	~
0x3f	?	0x5f	_	0x7a	<-

ASCII code of 16X16 fonts

Hex	Symbol
0x30	0
0x31	1
0x32	2
0x33	3
0x34	4
0x35	5
0x36	6
0x37	7
0x38	8
0x39	9

No. of 8X16 pattern

No.	Symbol
0	0
1	1
2	2
3	3
4	4
5	5
6	6
7	7
8	8
9	9

No. of 8X8 pattern

No.	Symbol
0	0
1	1
2	2
3	3
4	4
5	5
6	6
7	7
8	8
9	9

No. of 16X16 pattern

No.	Symbol
0	0
1	1
2	2
3	3
4	4
5	5
6	6
7	7
8	8
9	9

*UNLESS OTHERWISE SPECIFIED TOLERANCES PER DECIMAL PRECISION ARE: X=±1 (±0.030), X.X=±0.5 (±0.020), X.XX=±0.25 (±0.010), X.XXX=±0.127 (±0.005), LEAD SIZE=±0.05 (±0.002), LEAD LENGTH=±0.75 (±0.030), MIN=^{+0.00}/_{-0.00} DECIMAL PRECISION MAX = ^{+0.00}/_{-0.00} DECIMAL PRECISION

ezDisplay P8 OUTDOOR DOT MATRIX, 32*16 PIXEL, RGB LEDs, UART INTERFACE.

DATE : 2018.07.12 DRAWN BY : C.C.
 PAGE : 6 OF 8 CHKD BY : E.C.
 SCALE : NTF APRVD BY : G.Y.
 UNIT : mm [INCH]